

# Put Up A Bird Box

 30 minutes- 2 hours

 Medium

 Moderate

BRING BIRDS BACK



## A guide to building or putting up a bird box, helping to bring birds back in your area.

### Why?

---

Birds are in decline! There is a shortage of natural nesting sites playing a part in the decline of some of the UK's most iconic species because of development destroying trees, hedges and old buildings.

Bird boxes placed in gardens can make a real difference to the success or failure of a breeding species in an area, especially when accompanied by the regular supply of suitable food and water.

### What do I need?

---

You can build your own box from scratch using wood and nails, buy a ready to assemble bird box kit or if you don't have much time but want to help, there are lots of pre-made bird boxes and nesting cups available to buy.

Make sure to wild your garden to provide the food necessary for common garden birds to feed their chicks successfully.

### When?

---

Traditionally bird boxes are put up in the Spring ready for nesting season. However it is never too early or too late to put up a bird box. Some birds will use the boxes during the autumn and winter to roost or perhaps to feed. They often use the same boxes for nesting the following spring.

# Get going and follow these simple steps:

**Step 1:** Decide what type of bird you want to attract to your garden

Species such as swifts, swallows and house martins require specialist boxes as they nest under eaves and gable ends of buildings. Different birds will require different openings on the box.

**Step 2:** Chose if you want to buy or build a bird box

**Step 3:** Build your bird box

Follow the instructions in your kit or use the guide below to build a box from scratch

**Step 4:** Decorate your bird box

Make sure you use a water-based paint and not lead-based paints or creosote, as these are toxic to birds.

**Step 5:** Put up your bird box

Face as close to North east as possible to avoid overheating or getting too wet.

Ensure your box is at least 2 meters off the ground, out of reach from predators.

**Step 6:** Watch as birds come to visit.

**Step 7:** Clean your bird box

Clean out your box with warm soapy water once a year, 2-3 weeks after any birds have fledged. This will help to prevent disease and ensure that the box is ready for new occupants next year.



## How to make a nest box



### What you need:

- rough cut timber
- some old rubber or a hinge
- 20mm nails
- tools:

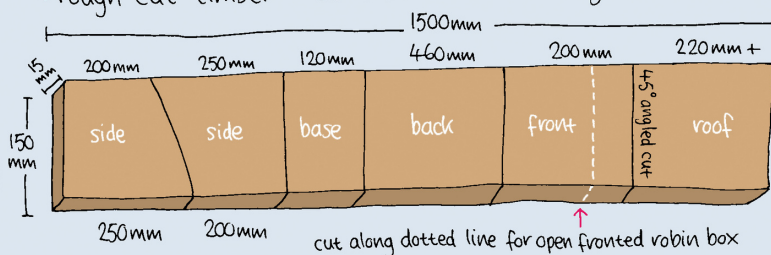

- ▶ saw
- ▶ hammer
- ▶ hand brace or drill
- ▶ pencil, ruler and scissors

always get an adult to help with tools!

### 1 Mark out and saw panels

Use diagram above, and write the name of each panel onto the marked out wood.

### 2 Choose your box type



hole fronted box:  
blue tits (25mm)  
great tits (28mm)  
sparrows (38mm)  
starlings (45mm)

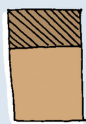

open fronted box for robins

### 3 Assemble the box

Nail the panels together:

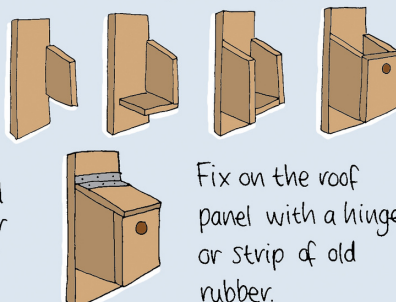

Fix on the roof panel with a hinge or strip of old rubber.

### Where to put it:

2-5 metres above the ground, somewhere sheltered.

2-5m above ground

